

# Respimat Soft Mist Inhaler (SMI)



THE OHIO STATE UNIVERSITY  
WEXNER MEDICAL CENTER

The soft mist inhaler (SMI) gives medicine deep into your lungs. Talk to your health care provider if you have questions about how to use your inhaler.

## Parts of the inhaler

Use the pictures as a guide as you review the parts of your inhaler. Check the instructions that come with your inhaler each time you open a new one to be sure nothing has changed.

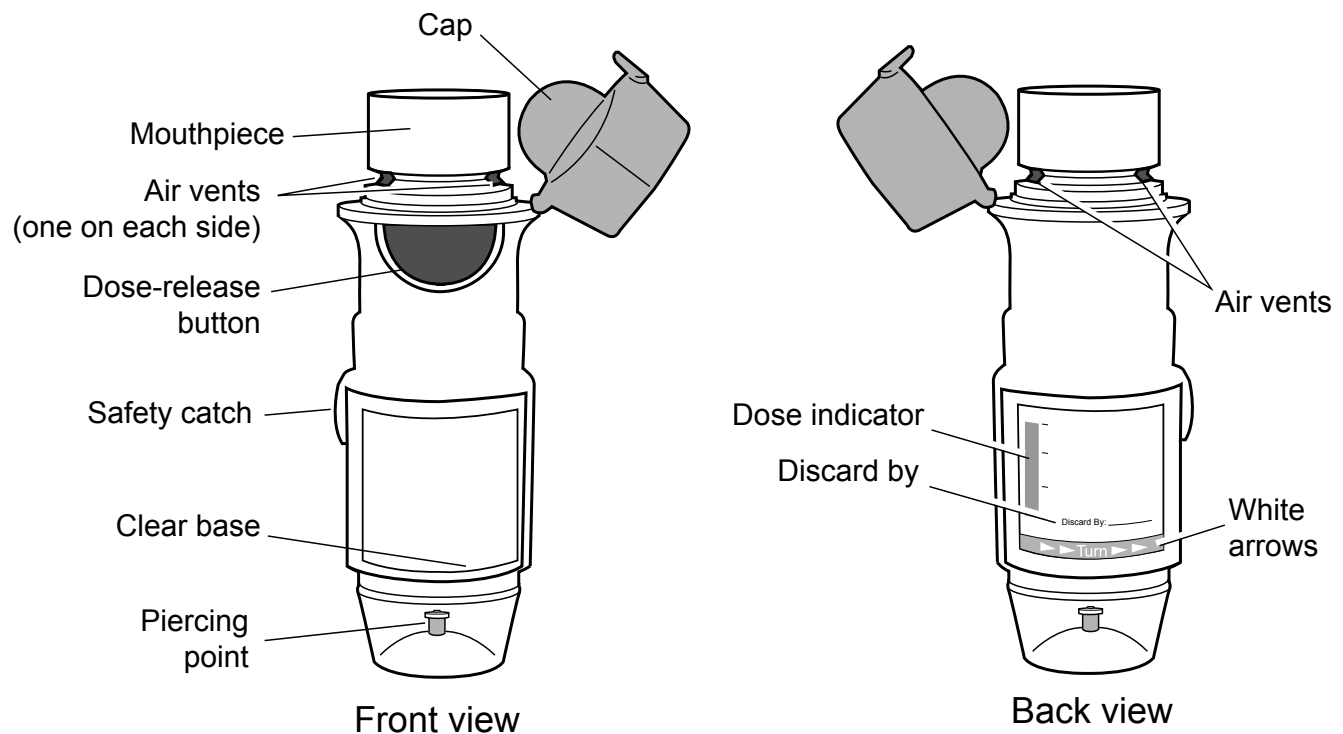

## How to get the inhaler ready

1. Wash your hands well with soap and water. Rinse with clean water and dry your hands with a towel.
2. Open the inhaler package and remove the plastic inhaler and metal cartridge. Set the cartridge to the side.
3. Push in on the Safety Catch button and pull the clear base off.

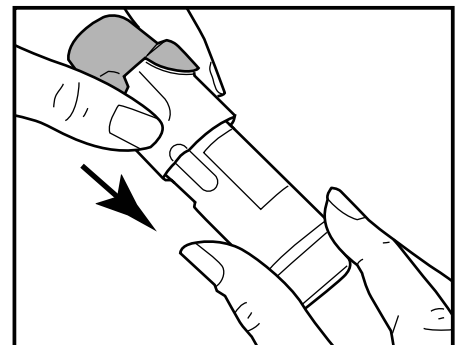

4. Write in the date you should discard the inhaler on the label on the back of the inhaler. You should discard the inhaler 3 months after you put the cartridge in.
5. Pick up the cartridge and push the narrow end into the inhaler. Put the cartridge end on a table or counter top and push down. The cartridge will stick out just past the inhaler when it is in correctly.

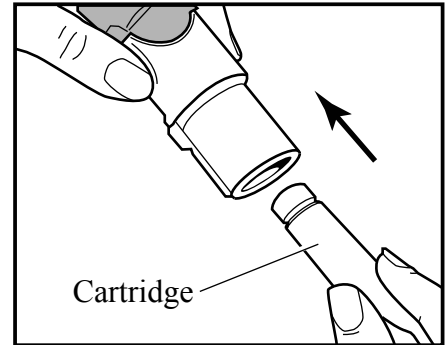

6. Put the clear base back on the inhaler. You should not take the inhaler apart after you have it ready for use.

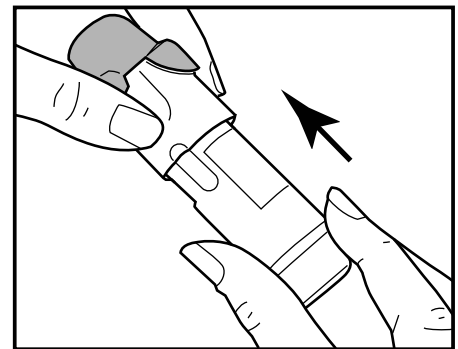

## How to prime the inhaler

At times, you will need to prime the inhaler to insure you get the right amount of medicine with each dose. **Prime the inhaler if:**

- **It is new.**
- **You have not used the inhaler for more than 3 days.**  
Follow steps 1 to 4 to get the inhaler ready for use.
- **You have not used the inhaler for more than 21 days.**

### Follow these steps:

1. Hold the inhaler upright with one hand on the cap and one hand on the clear base.
2. Turn the clear base in the direction of the white arrows on the label until it clicks. It will be about half a turn.

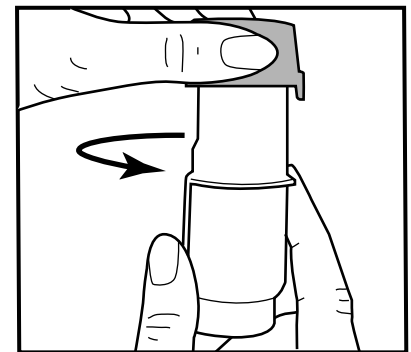

3. Open the orange cap.

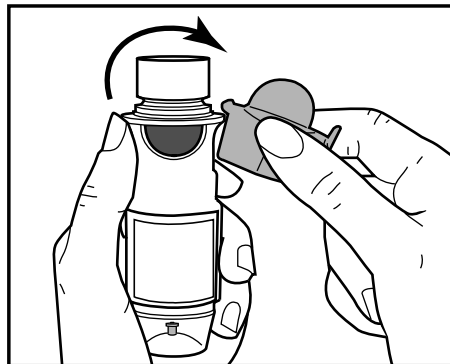

4. Point the inhaler away from you towards the ground and **press the dose release button**.

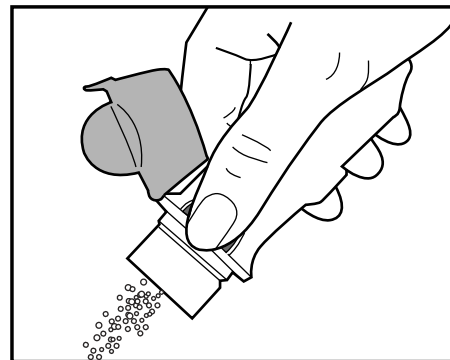

5. Close the cap and then repeat steps 1 through 4 until you see a spray of mist.
6. When you see the spray, repeat steps 1 through 4 **three more times** to be sure the inhaler is ready to use.
7. After you prime the new inhaler, you will have 120 doses left.

## How to take your dose

1. Hold the inhaler upright with one hand on the cap and one hand on the clear base.
2. Turn the clear base in the direction of the white arrows on the label until it clicks. It will be about half a turn.

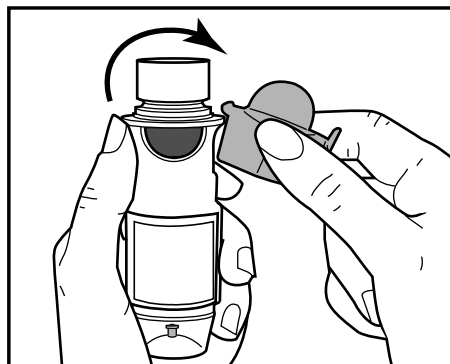

3. Open the orange cap.

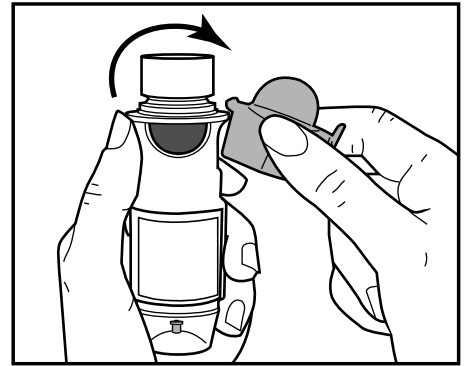

4. Breathe out and close your lips around the mouthpiece, pointing the inhaler to the back of your throat. **Do not cover the air vents.**
5. Push the dose release button while taking in a slow deep breath through your mouth.
6. Hold your breath for 10 seconds or as long as you can.

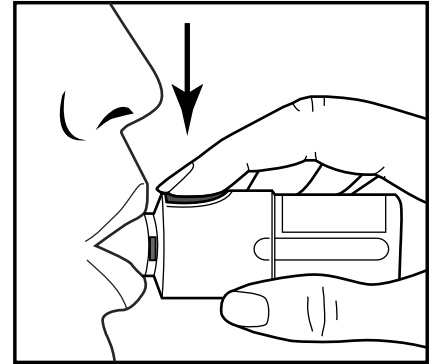

7. Remove the inhaler and put the cap back on the mouthpiece.
8. Rinse your mouth with water and then spit the water out. Do not swallow the water.
9. Put the inhaler away until your next dose is due.

---

**Talk to your doctor or health care team if you have any questions about your care.**

The Library for Health Information is available to help you find more health information at (614) 293-3707 or e-mail: [health-info@osu.edu](mailto:health-info@osu.edu).